

| Num. parte | Materiale | Peso | A° | R | Hr | Hv |
|------------|--------------|--------|-----|-----|-----|--------|
| 30-R08 | 1.0503 (C45) | 14.773 | 30° | 0,8 | 115 | 117,29 |

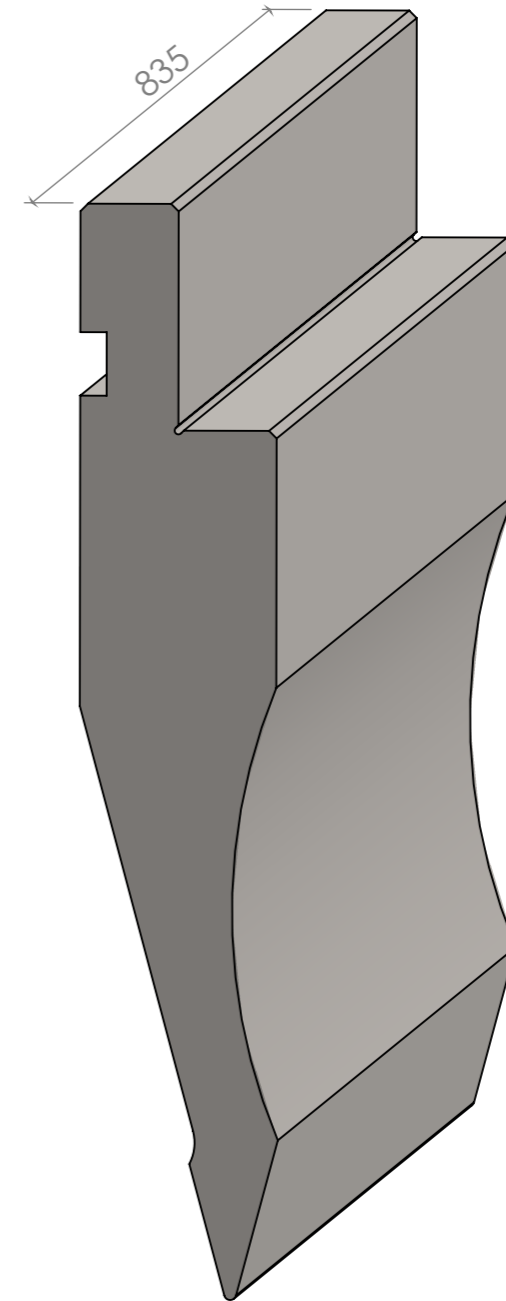
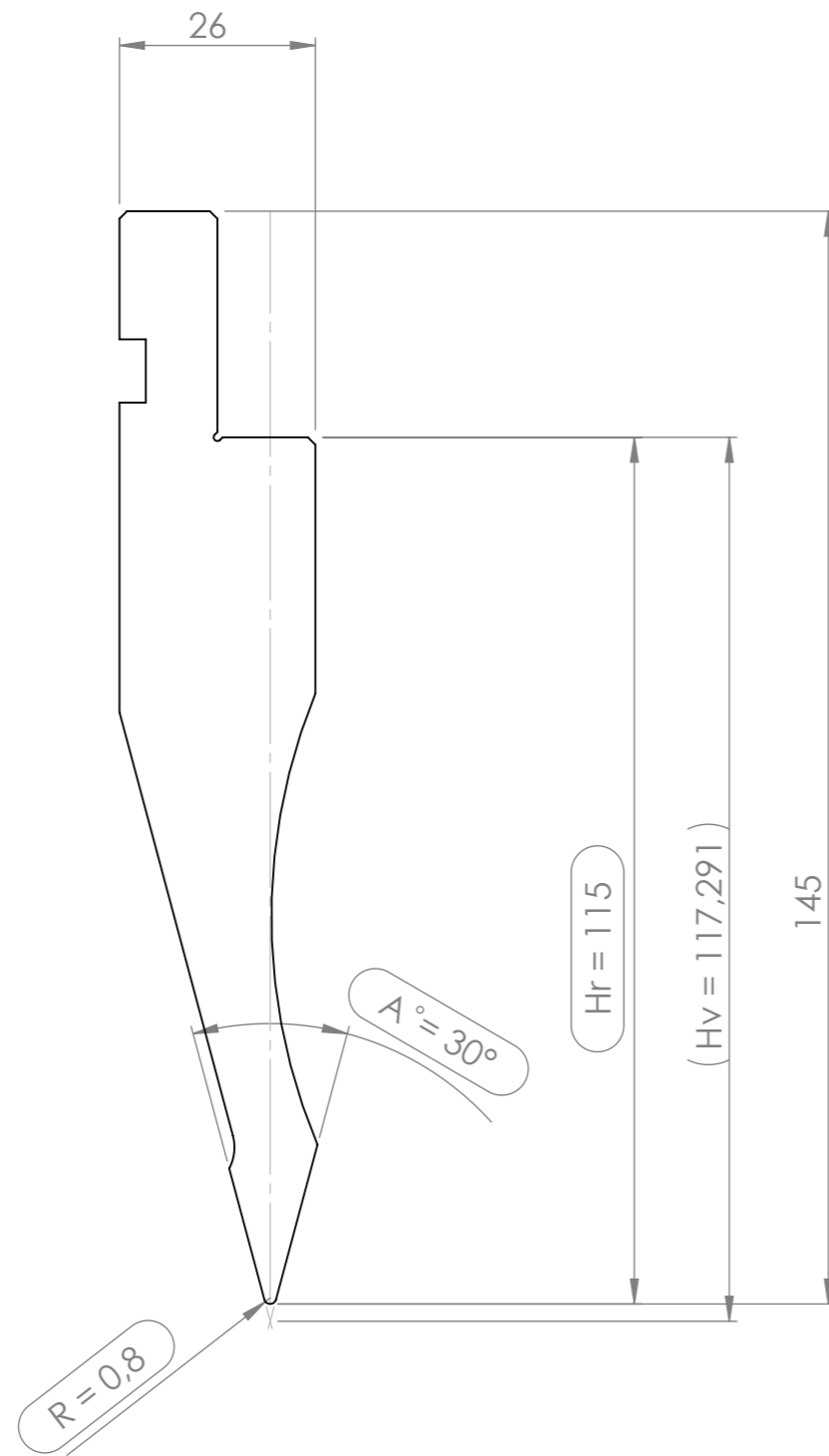

CARICO MAX: 686 kN/m

TRATTAMENTO TERMICO
Temprato a Induzione HRC 52-58

PUNZONE SERIE PS 1033