

| Num. parte | Materiale | Peso | A° | R | Hr | Hv |
|------------|---------------------|--------|-----|---|-----|-----|
| PS-1036 | 1.7225 (42CrMo4) | 20.449 | 60° | 2 | 145 | 147 |

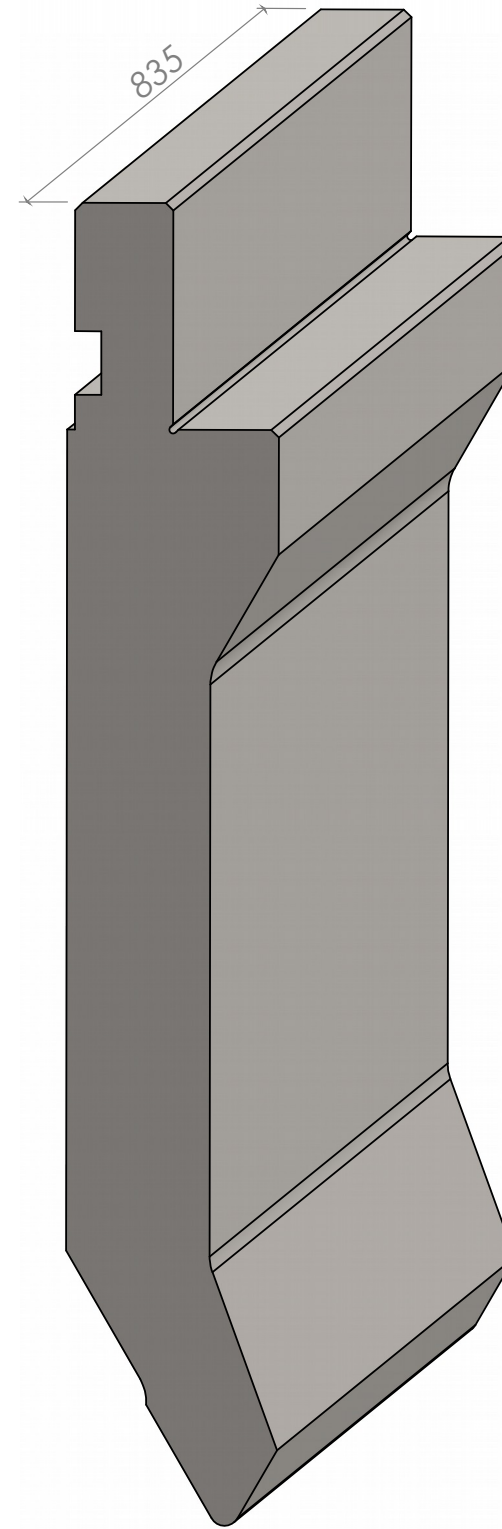
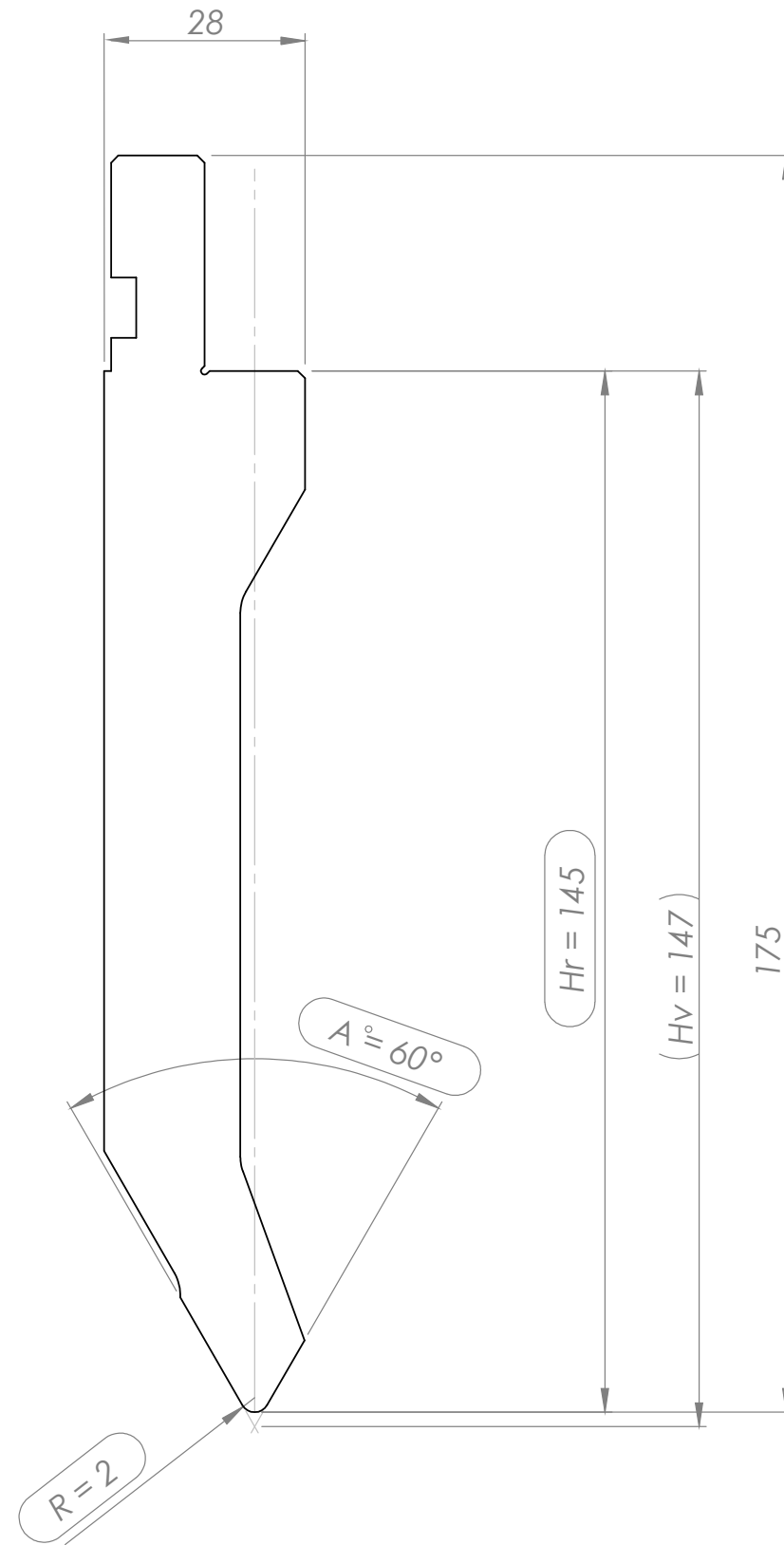

CARICO MAX: 800 kN/m

TRATTAMENTO TERMICO
Temprato a Induzione HRC 52-58

PUNZONE SERIE PS 1036