

Num. parte	Materiale	Peso	A°	R	Hr	Hv
PS-1039	1.7225 (42CrMo4)	16.965	26°	0,8	145	147,76

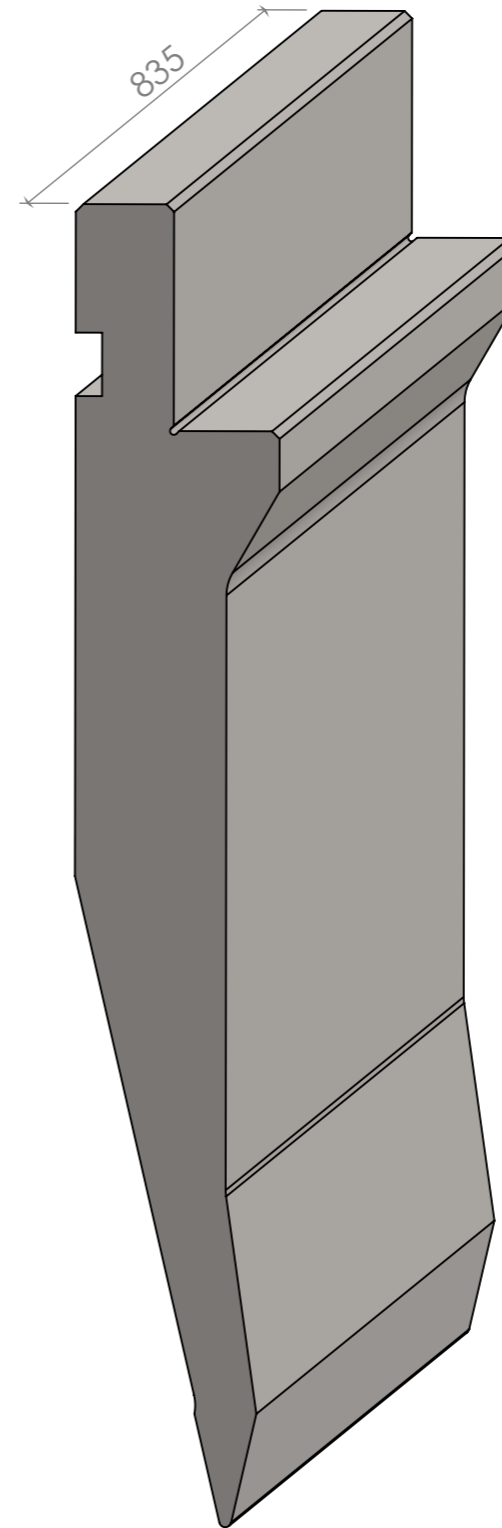
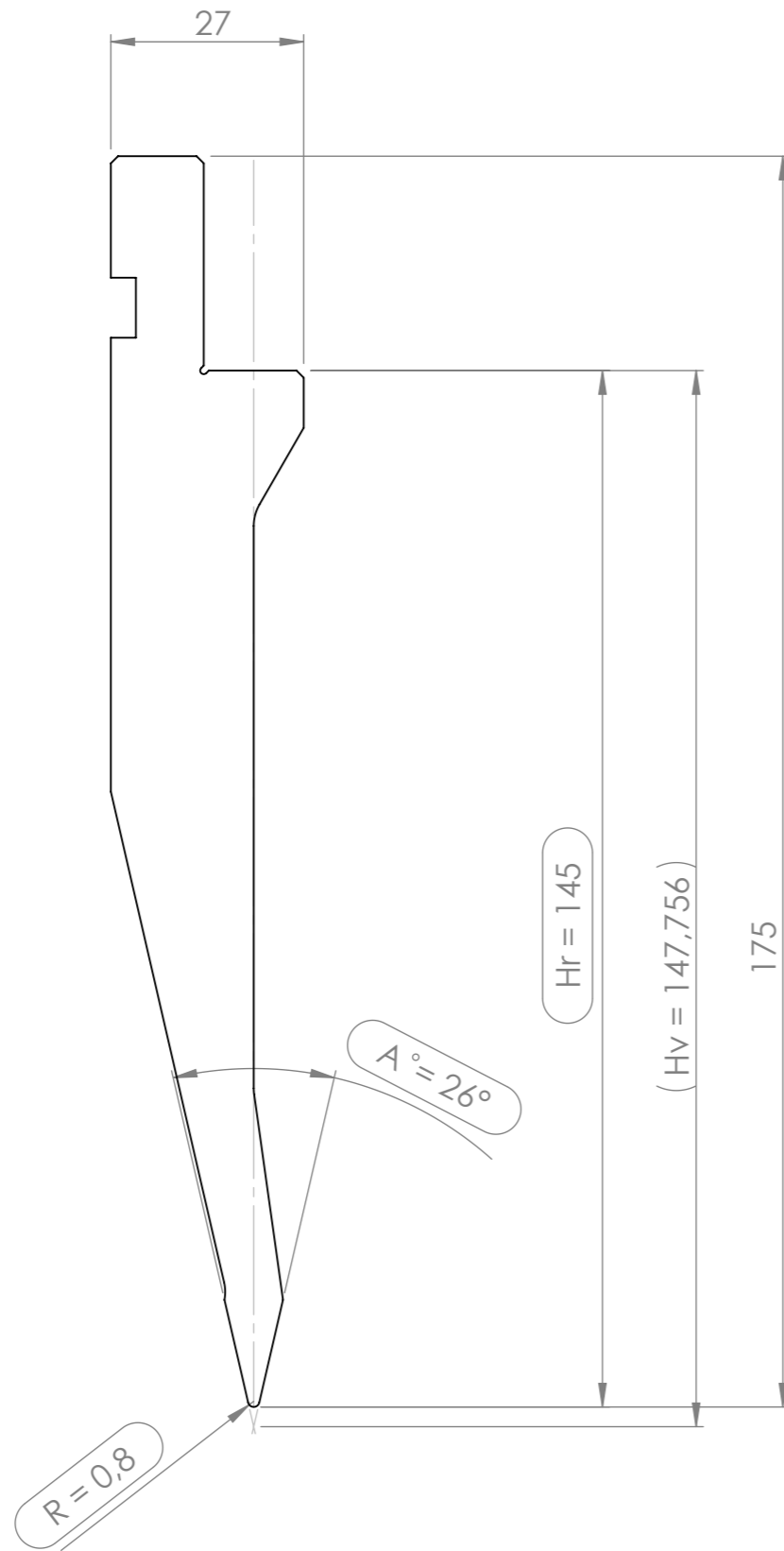

CARICO MAX: 750 kN/m

TRATTAMENTO TERMICO
Temprato a Induzione HRC 52-58

PUNZONE SERIE PS 1039