

Num. parte	Materiale	Peso	A°	R	Hr	Hv
PS-1040	1.7225 (42CrMo4)	19.426	26°	1,5	145	150,17

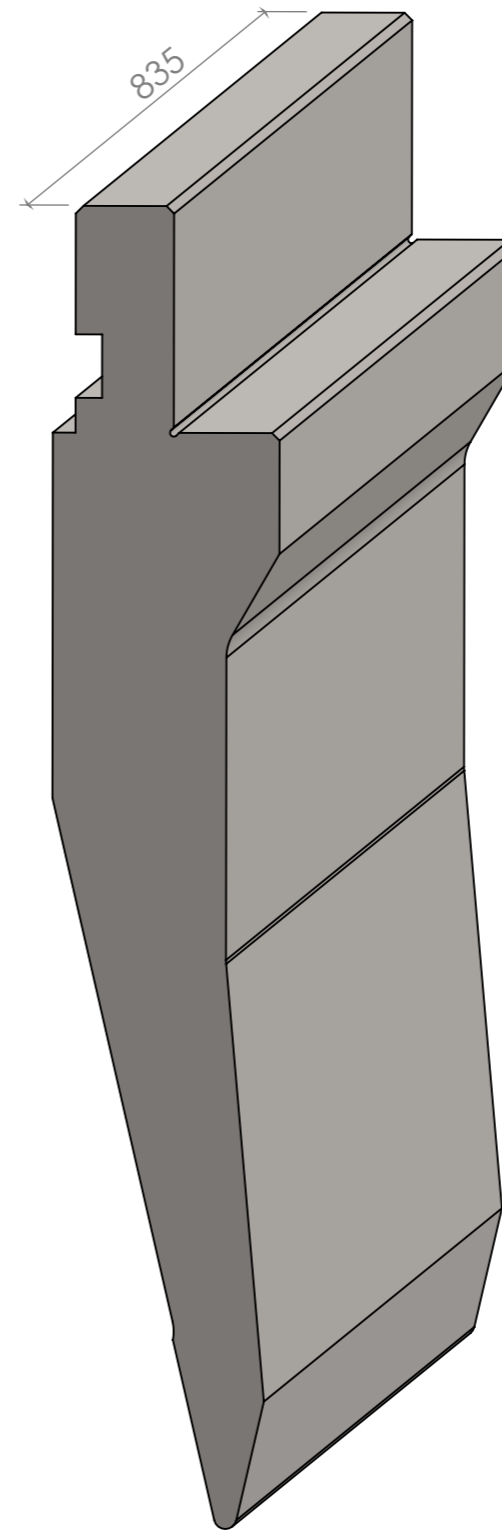
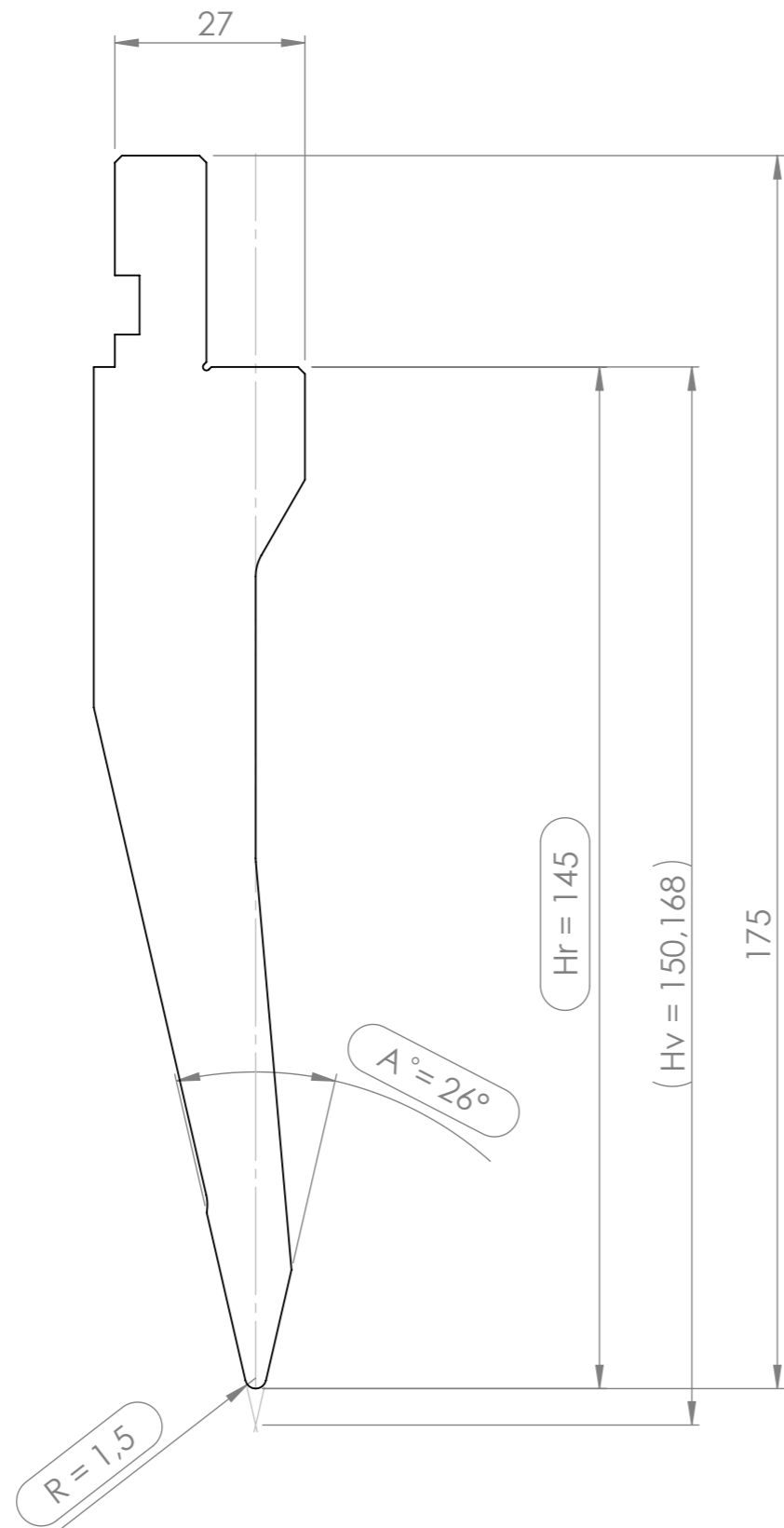

CARICO MAX: 1000 kN/m

TRATTAMENTO TERMICO
Temprato a Induzione HRC 52-58

PUNZONE SERIE PS 1040